

LAKE SURVEY MAP

POSKIN
LAKE

BARRON
COUNTY

SEC. 15, 16

T. 34

N. R. 13

E.W.

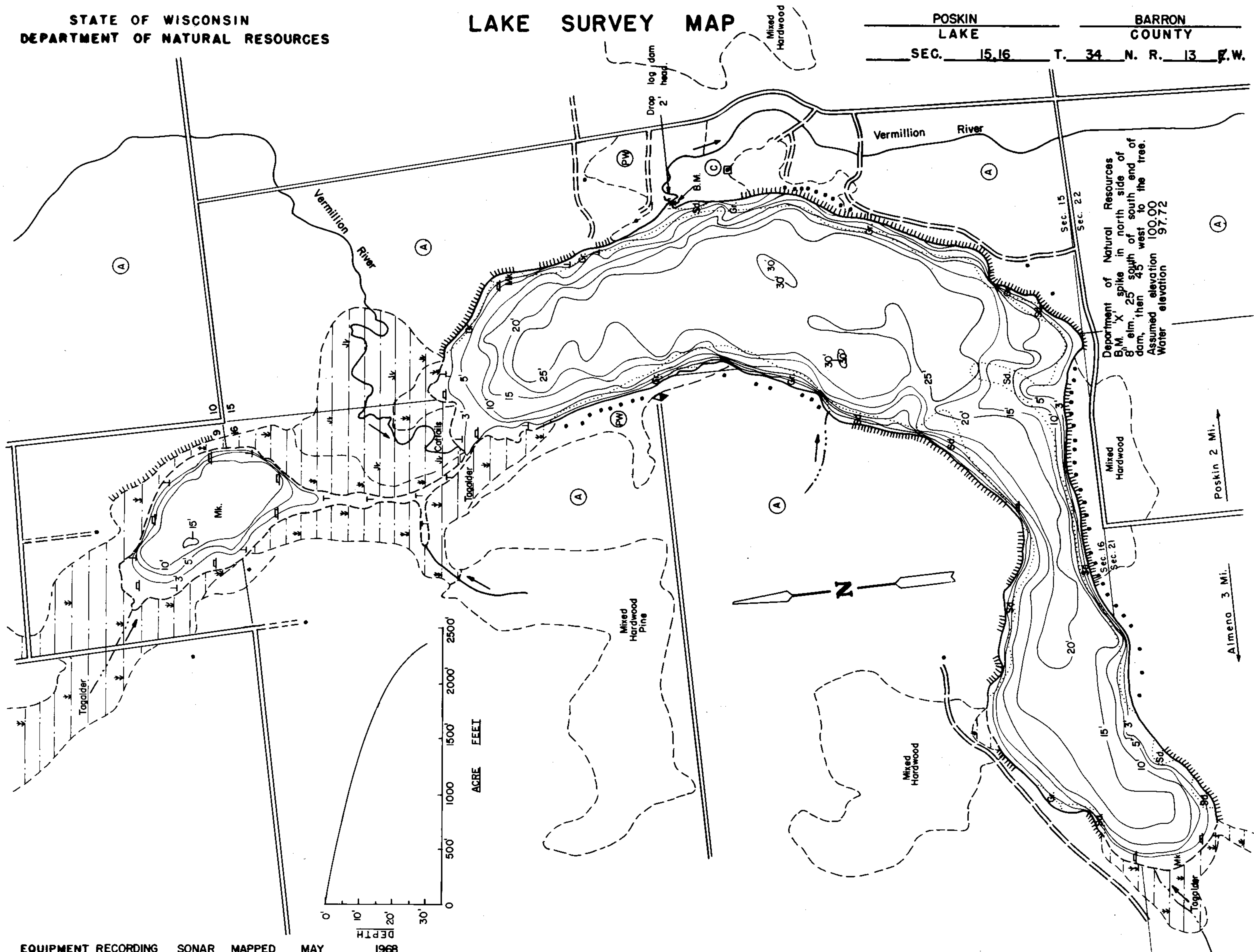

Department of Natural Resources
B.M. 'X' spike in north side of
dam, 25' south of south end of
dam, then 45' west to the tree.
Assumed elevation 100.00
Water elevation 97.72

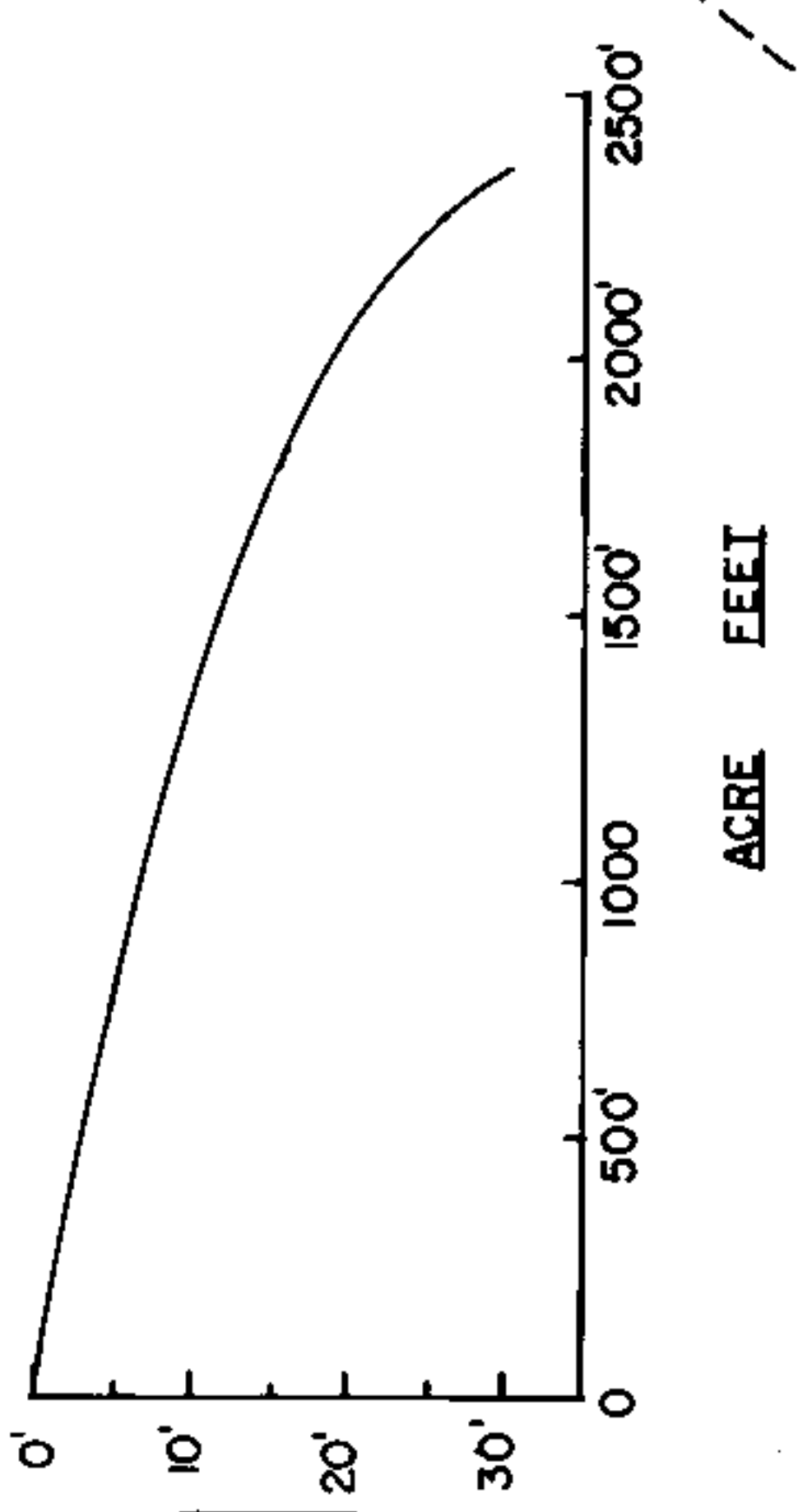

EQUIPMENT RECORDING SONAR MAPPED MAY 1968

TOPOGRAPHIC SYMBOLS

- ⊙ Brush
- ⊙ Partially wooded
- ⊙ Wooded
- ⊙ Cleared
- ⊙ Pastured
- ⊙ Agricultural
- B.M. Bench Mark
- Dwelling
- Resort
- Camp
- ⊙ Steep slope
- ⊙ Indefinite shoreline
- ⊙ Marsh
- ⊙ Spring
- ⊙ Intermittent stream
- ⊙ Permanent inlet
- ⊙ Permanent outlet
- D.N.R. State owned land

LAKE BOTTOM SYMBOLS

- P. Peat
- Mk. Muck
- C. Clay
- M. Marl
- Sd. Sand
- Sl. Silt
- Gr. Gravel
- R. Rubble
- Bc. Bedrock
- ⊙ Boulders
- ⊙ Stumps & Snags
- ⊙ Rock danger to navigation
- T Submergent vegetation
- ⊙ Emergent vegetation
- ⊙ Floating vegetation
- ⊙ Brush shelters



Access Access with Parking Boat Livery

Drawn by: R. Ripp
Field work by: C. Busch, C. Olson, L. Sather

SPECIES OF FISH	ABUNDANCE		
	Abundant	Common	Present
Muskie			
N. Pike			
Walleye		X	X
L. M. Bass		X	X
S. M. Bass		X	X
Panfish	X		
Trout			

WATER AREA 150.0 ACRES
 UNDER 3 FT. 15.0 %
 OVER 20 FT. 37.7 %
 MAX. DEPTH 30 FEET.
 TOTAL ALK. 82 P.P.M.
 VOLUME 2348.2 ACRE FT.
 SHORELINE 4.09 MILES

Source: Wisconsin Department of Natural Resources 608-266-2621
Poskin Lake – Barron County, Wisconsin DNR Lake Map
Date – May 1968 - Historical Lake Map - Not for Navigation
A Public Document - Please Identify the Source when using it.