

P.S.C. B.M. - 1155 - A. Bronze tablet set in concrete post. Located 55' NW corner of both house 74' S. of lake, 2.5 N. of row of guard post.
Assumed elev. 100.00
Water elev. 87.18

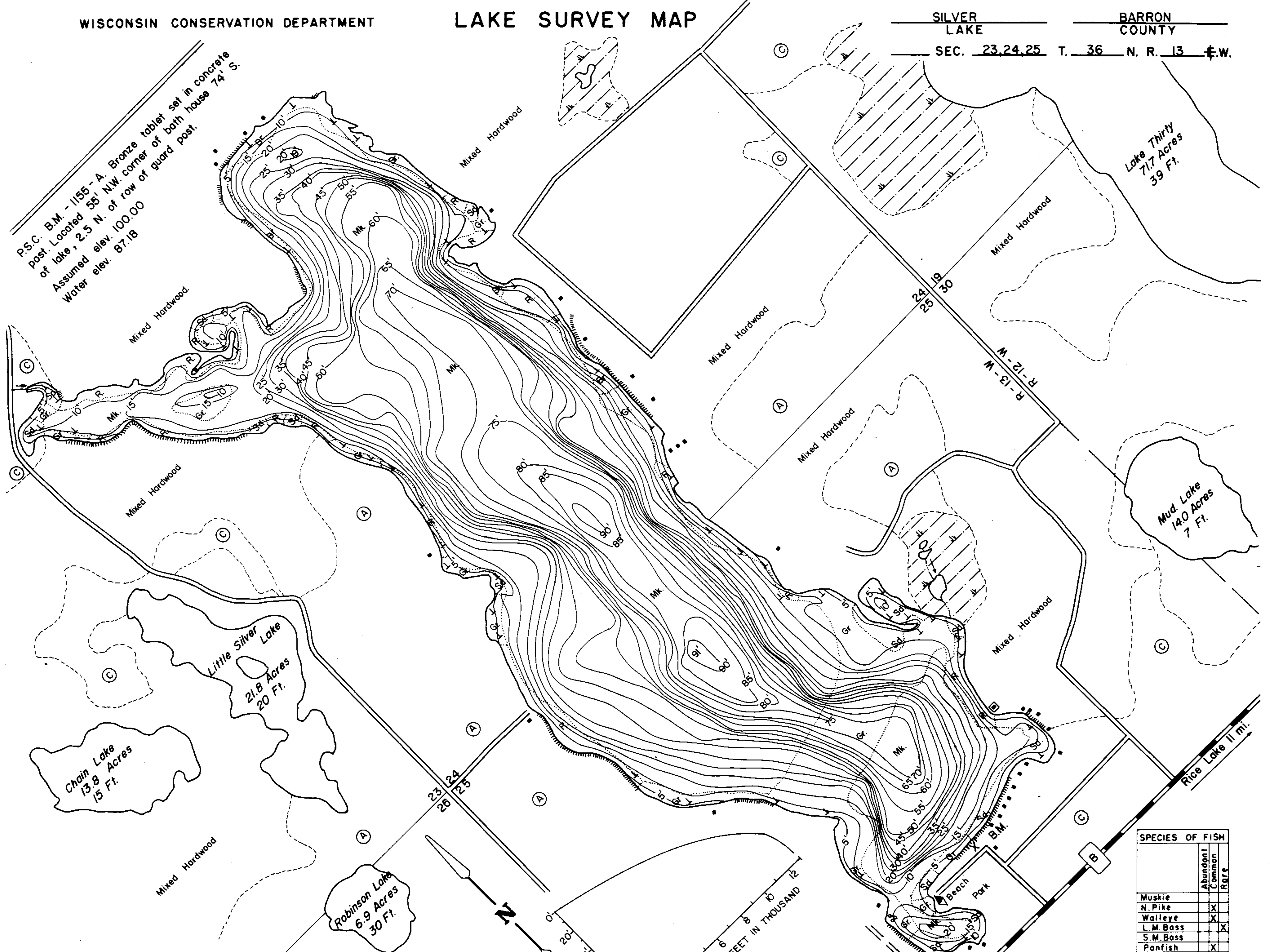

EQUIPMENT RECORDING SONAR MAPPED JULY 1967
MO. YR.

- TOPOGRAPHIC SYMBOLS
- (B) Brush
 - (P) Partly wooded
 - (W) Wooded
 - (C) Cleared
 - (A) Pastured
 - (A) Agricultural
 - B.M. Bench Mark
 - Dwelling
 - Resort
 - ||||| Steep slope
 - - - Indefinite shoreline
 - Marsh
 - Spring
 - Intermittent stream
 - Permanent inlet
 - Permanent outlet
 - Dam

WATER ELEV. 87.18

- LAKE BOTTOM SYMBOLS
- P. Peat
 - Mk. Muck
 - C. Clay
 - M. Marl
 - Sd. Sand
 - St. Silt
 - Gr. Gravel
 - R. Rubble
 - Br. Bedrock
 - T Submergent vegetation
 - I Emergent vegetation
 - F Floating vegetation
 - Stumps & Snags

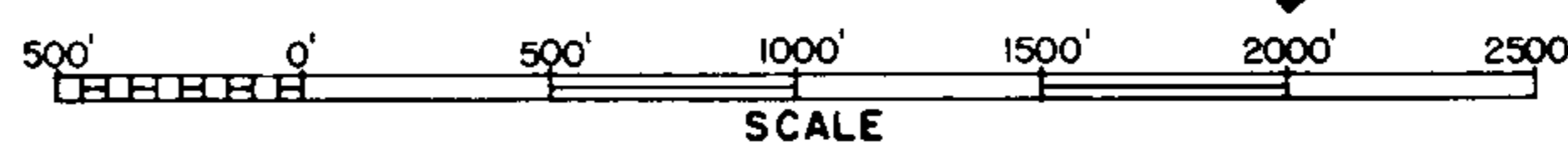

Access Access with Parking Boat Livery
Field work by: C. Busch, G. Winter, L. Sather. Drawn by: C. Holt

SPECIES OF FISH	Abundant	
	Common	Rare
Muskie		
N. Pike	X	
Walleye	X	
L.M. Bass		X
S.M. Bass		X
Ponfish	X	
Trout		X

AREA 336.7 ACRES
UNDER 3 FT. 1.3 %
OVER 20 FT. 66.5 %
VOLUME 12,792.7 ACRE FT.
TOTAL ALK. 15 P.P.M.
SHORELINE 4.4 MILES
MAX. DEPTH 91 FEET

Source: Wisconsin Department of Natural Resources 608-266-2621
Silver Lake – Barron County, Wisconsin DNR Lake Map
Date – Jul 1967 - Historical Lake Map - Not for Navigation
A Public Document - Please Identify the Source when using it.